

021-34095728

## Snap-tite CNG 1" Hi-Flow Inline Breakaway Coupling

Model : B049-21



B049-21 ASSEMBLED UNIT

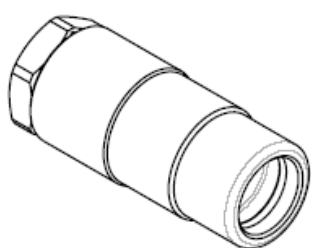

B049-2  
COUPLER ASSEMBLY

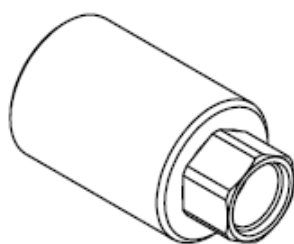

B049-3  
NIPPLE ASSEMBLY

Snap-tite 1" Hi-Flow Inline breakaway coupling is designed specifically for used in filling lines for filling storage trailers at CNG Mother-stations .

When properly installed, this hi-flow inline breakaway couplings allows for the safe disconnection from the fueling system without damage to the filling equipment in the event of an accidental disconnect (drive-off).

Due to its hi-flow design, there is minimum pressure drop across this breakaway coupling , thus allowing maximum flow through it.

### Features

- Combination of corrosive resistant stainless steel (303, 316 & 17-4PH)
- Seal specially design for CNG
- Large flow surface to handle high flow rate with minimum pressure drop
- Disconnect force : 75 - 175 lbs. (333.6 - 778.3 N) at any pressure up to operating
- Superior flow characteristics
- Heavy-duty design for durability
- Balanced design assures positive connection until a breakaway cycle is required
- Easy installation
- Reusable following breakaway with minimal repair

**Working Pressure :** 3600 psi (248 bar)

**Burst Pressure :**

Stainless Steel : 20,000 psi  
(1,378 bar)

**Temperature Range :**

-40°F to 250°F / -40°C to 121°C

**Weight :** 6.60 lbs (3.00 kg)

**Flow Rate :** 4200 SCFM (7135 Nm<sup>3</sup>/hr)

**Material :** 303, 316 & 17-4PH  
Stainless Steel

**Seal Material :** Special UR seal for CNG

**Connection :** 1" Female NPT

